

TRAC VAC

Model 1060



Operating and Assembly Manual

**Midwest Equipment Manufacturing, Inc.
5225 Serum Plant Road
Thorntown, IN 46071**

SAFETY RULES

Remember, any power equipment can cause injury if operated improperly or if the user does not understand how to operate the equipment. Exercise caution at all times when using power equipment.



This symbol means Attention!!!! It is used to point out safety precautions.

- Read and follow all instructions in this manual before assembly or operation of this equipment. Failure to comply with these instructions may result in personal injury. Keep this manual for future reference and for ordering replacement parts.
- Read this instruction manual carefully. Become familiar with the controls and proper use of this equipment.
- Read the engine owners manual and safe operation rules before using this equipment.
- Never allow children less than 16 years of age to operate the Trac-Vac. Children 16 years and older should operate **only** under close parental supervision.
- Do not allow anyone to operate this equipment without proper instruction.
- Do not allow passengers to ride on the Trac-Vac or on the towing vehicle.
- Keep children and pets out of area of operation.
- Check fuel before starting engine. **Do Not** fill fuel tank indoors, or while engine is running or hot. Wipe off any spilled fuel before starting engine.
- Engine and muffler get **HOT! Do Not** touch! Keep debris from accumulating on or around engine and muffler to avoid fire hazard.
- Allow engine to cool before storing in any enclosed area. Never store Trac-Vac with fuel in tank.
- Do not operate engine if air cleaner or cover is removed, except for adjustments. Removal of the part could create a fire hazard.
- Keep hands, feet, face, long hair and clothing out of inlet and discharge areas. There are **ROTATING BLADES** inside these openings.
- Make certain that all moving parts come to a complete stop before cleaning, repairing or inspection. Disconnect spark plug wire and keep away from plug to prevent accidental starting.
- If Trac-Vac should become clogged with debris, **SHUT OFF ALL ENGINES** and wait until comes to a complete stop before attempting to remove obstruction. Disconnect spark plug wire to prevent accidental starting.
- If excessive vibration occurs while operating your Trac-Vac, stop the engine immediately, disconnect the spark plug wire and allow all moving parts to stop completely before taking the following steps.
 - A. Inspect for damage.
 - B. Repair or replace any damaged parts.
 - C. Check for loose parts and tighten to assure continued safe operation.
- Check all hardware periodically to insure safe operation.
- Check cart cover periodically for wear and replace if worn or damaged.
- **Never** operate Trac-Vac without intake hose and exhaust hose attached in proper place.
- **Do Not** remove exhaust hose or attempt to empty contents of container while engine in running.
- Keep all shields and guards in place and securely attached.
- Always wear eye protection (safety glasses or goggles) when operating this equipment.
- **Do Not** stand behind unit in exhaust discharge area while engine is running.
- **Do Not** operate this equipment while intoxicated or while taking medications that could impair reactions or senses.
- Operate this equipment at reduced ground speed on rough terrain, along creeks and ditches and on slopes to prevent tipping or loss of control.
- Vehicle stability and braking are affected by the addition of this unit. Do not fill the Trac-Vac to its full capacity without checking the capability of the towing vehicle to safely pull and stop with the unit attached.
- **Do Not** operate on slopes in excess of 10 degrees. **STAY OFF OF STEEP SLOPES!**
- Follow the maintenance instructions outlined in this manual.



Trac-Vac Model 1060

Drawbar Kit
Part No. 10620

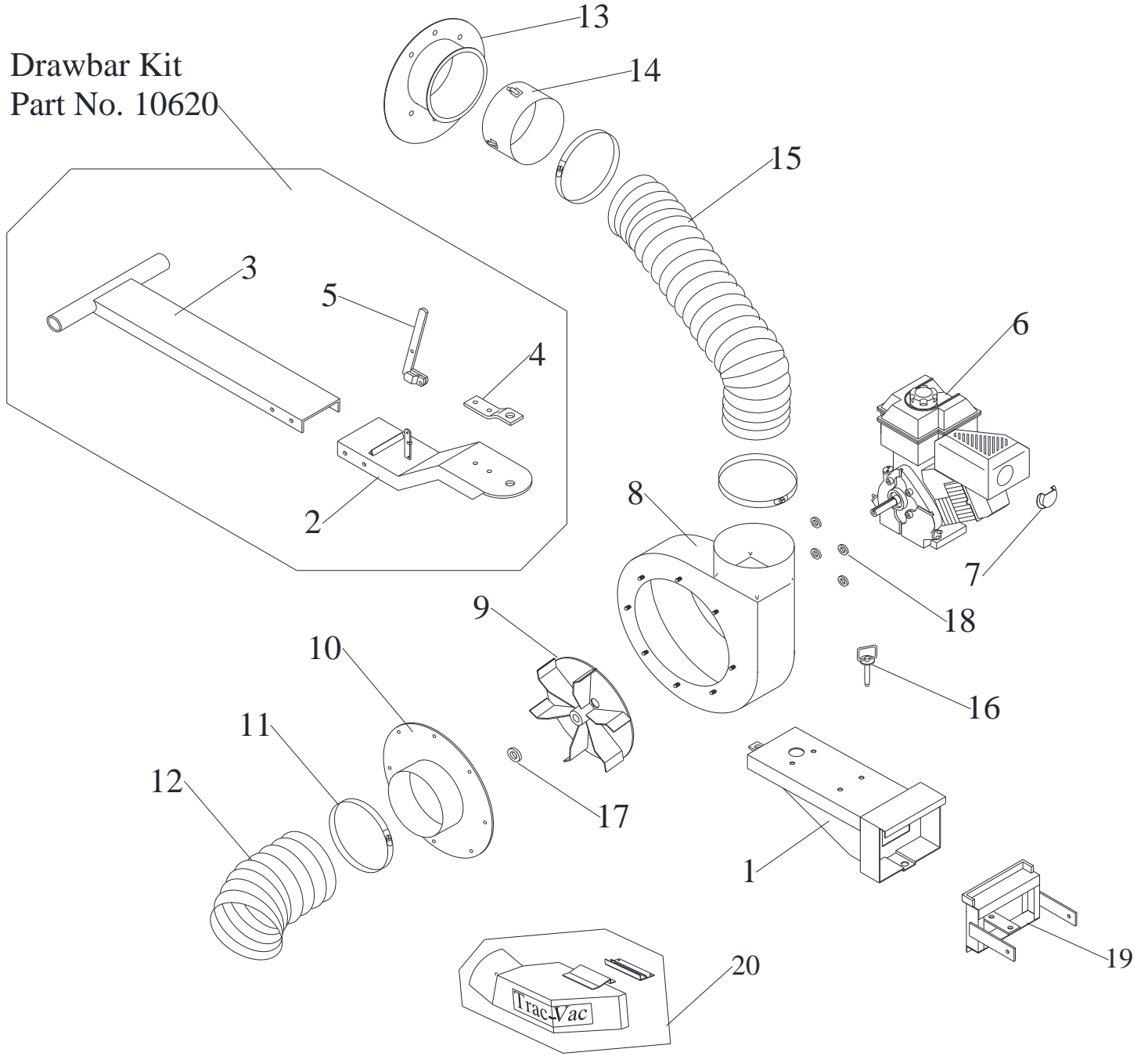

11-11-15

Key	Part No.	Description
1	10602	Frame, RH
2	10605	Extension, Drawbar
3	10606	Drawbar
4	58067	Hitch Plate (comes w/ cart)
5	58061	Cart Latch, 580
6	20122	Engine, 11 HP B&S Pull Start
	18113	Engine, 11 HP Electric Start
	52026	Engine, 12 HP LCT (414 CC)
7	86513	Muffler Deflector
	52047	Muffler Deflector (12 HP LCT only)
8	10601	Turbine Housing
9	20050	Turbine, 14"
10	66010	Inlet, 8" Straight
11	18119	Band Clamp, 8"
12	88101	Intake Hose, 8" x 7 1/2'
13	18070	Cart Connector, 8"
14	86060	Hose Connector, 8'
15	86101	Exhaust Hose, 8" x 4'
16	58104	Hitch Pin
17	86107	Turbine Washer
18	86027	Spacer, Housing
19	46***	Hitch (tractor specific)
20	*****	Chute (tractor specific)
	45131	Decal, Trac-Vac
	45133	Decal, Warning

Model 348/368L Cart Covers

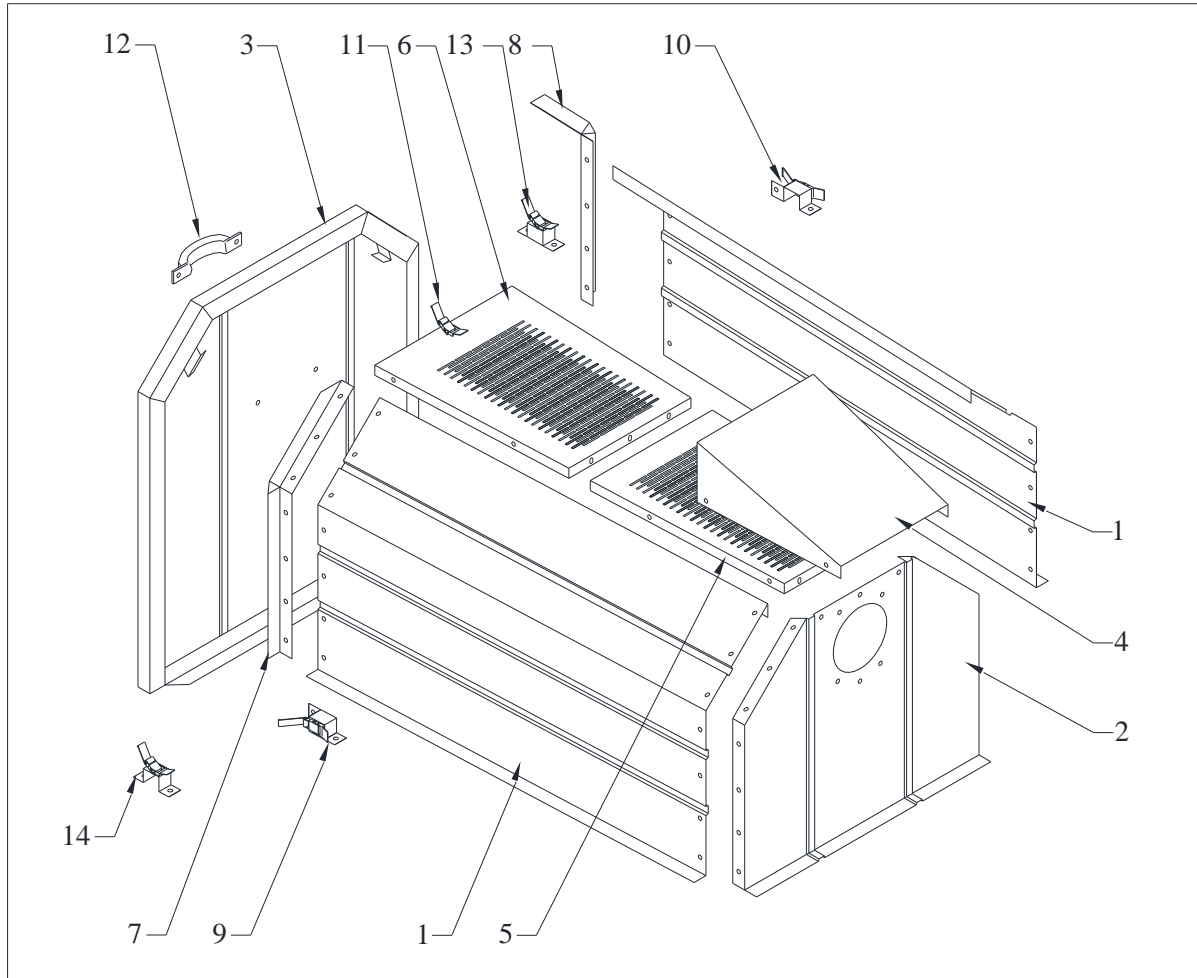

Model 280/348L Cart Cover

Model 280/368L Cart Cover

Key	Part No.	Description
1	28047	Side Panel
2	28030	Front Panel
3	28236	Tailgate
4	28232	Deflector
5	28242	Front Screen
6	28243	Rear Screen
7	28100	Rear Angle RH
8	28101	Rear Angle LH
9	28102	Latch Ass'y RH
10	28103	Latch Ass'y LH
11	28105	Top Latch
12	28104	Handle

Key	Part No.	Description
1	28059	Side Panel
2	28035	Front Panel
3	28238	Tailgate
4	28235	Deflector
5	28240	Front Screen
6	28241	Rear Screen
7	28100	Rear Angle RH
8	28101	Rear Angle LH
9	28102	Latch Ass'y RH
10	28103	Latch Ass'y LH
11	28105	Top Latch
12	28104	Handle
13	28156	Latch Ass'y LH
14	28157	Latch Ass'y RH

Model 280 Cart Cover Assembly Instructions

NOTE: Do not tighten any bolts until the end of construction.

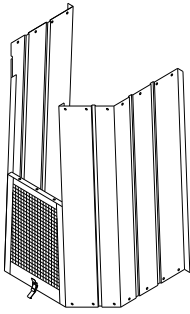

Place side panels on end with decal outward and about a foot apart at top. Place screen with latch, (rear screen), on end between sides with latch outward and to the floor. Attach to sides with 1/4 x 1/2 bolts.

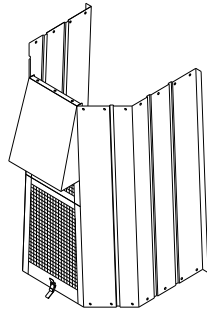

Place screen without latch, (front screen), on top of rear screen and between sides. Secure to rear screen with 1/4 x 1/2 bolts. Slip deflector between sides and front screen with tapered end up. Secure with 1/4 x 1/2 bolts.

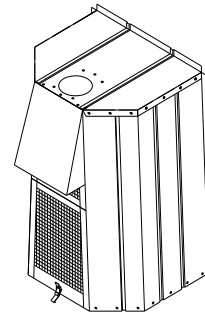

Place front on sides with flanges on outside. Start corner bolts in sides and screen before tightening. Start bolts at top & bottom of side panels and work your way toward center, with truss head, round, to the outside.

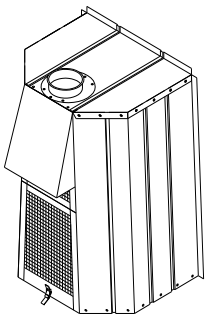

Place connector, (packed in with vac), on outside of front with the lip to the outside. Attach with 1/4 x 1/2 bolts.

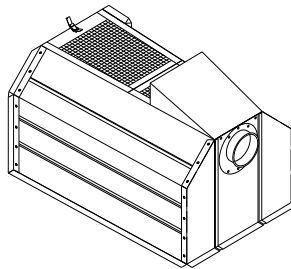

Place cover flat on floor and attach angles to side panels at rear of cover with angles on the outside of cover. Secure with 1/4 x 1/2 bolts. Start at the top and second hole from the bottom, (latch uses bottom hole), then work towards the center of the panels. Bolts truss, (round), head should be to the inside of cart.

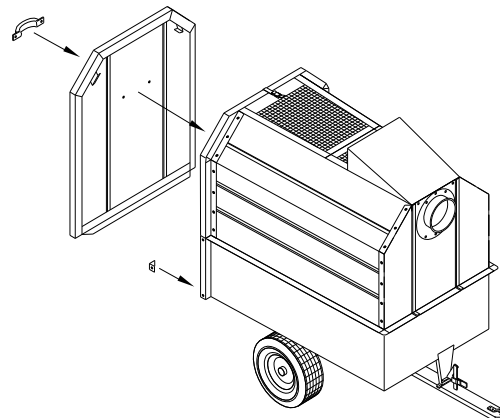

Attach handle to tailgate on smooth side. Place cover on cart. Make sure the two lower black angle brackets have been installed on the lower rear of the cart. Fit tailgate to the cover using the top latch and lower brackets only.

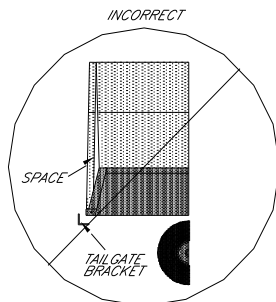
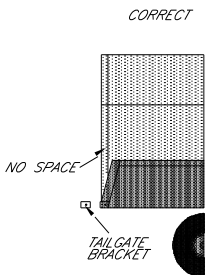

Gently move cover to the rear to insure contact between the tailgate and cover, (along entire contacting surface). Center front on cart. Mark hole locations, and drill 9/32" holes. Attach cover with 1/4 x 1/2 bolts.

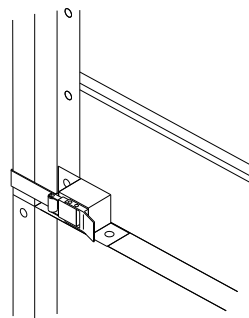

Place latch on each side of cart with tongue of latch to rear. Attach to side panel and cart with 1/4 x 1/2 bolts. Tighten all hardware.

280/368L Latch Bracket Installation

1. Remove whizlock nut shown in illustration (Fig. 1)
2. Place latch bracket over bolt and replace whizlock nut.
3. Mark and drill $\text{Ø}9/32$ " hole for the opposite end of latch bracket. (Fig. 2)
4. Attach latch bracket with 1/4-20 trusshead bolt & whizlock nut provided. (Fig. 3)
5. Repeat steps 1 thru 4 on opposite side of cart. (Fig. 4)

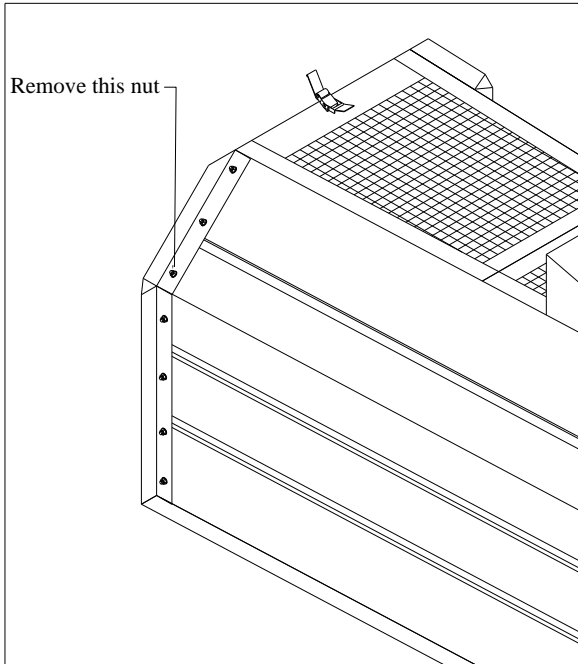

Fig. 1

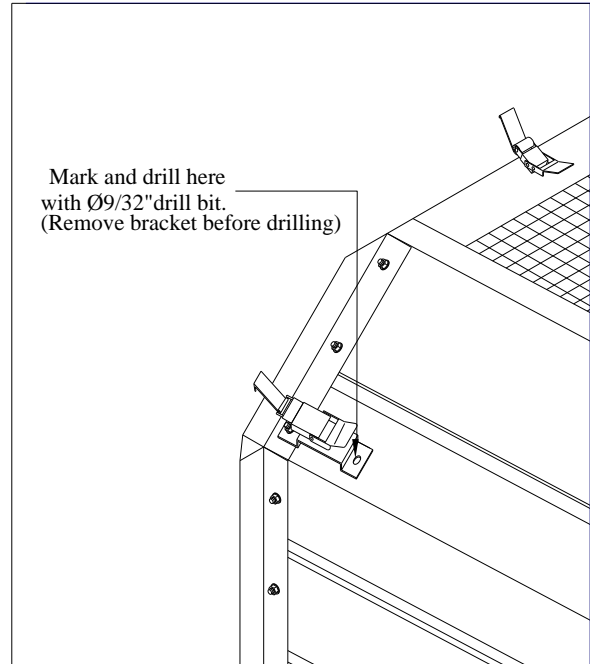

Fig. 2

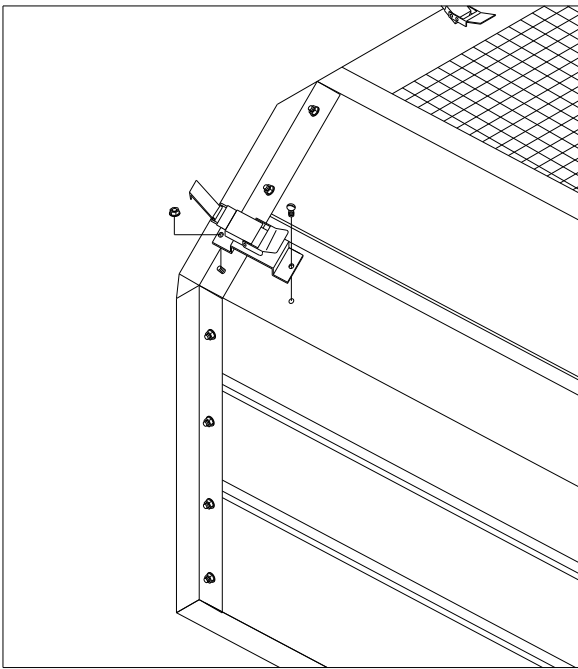

Fig. 3

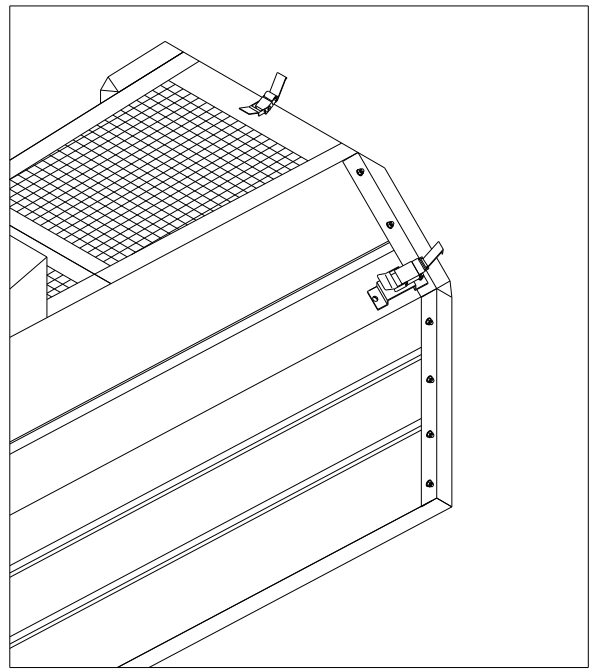

Fig. 4

MAINTENANCE



DANGER: The Trac-Vac was built to be operated according to the rules for safe operation in this manual. Carelessness or error on the part of the operator can result in serious injury. This unit is capable of amputating fingers or hands and throwing objects. Failure to comply with the safety instructions could result in serious injury or death.



CAUTION!!!
SPINNING BLADE

MAINTENANCE SCHEDULE	Before each use	After each use	Every season	Before Storage	Service Dates													
Check engine oil level	X																	
Check tire pressure	X																	
Check all hardware for tightness	X																	
Lubricate			X															
Clean		X		X														
Maintain engine per engine manual																		

BEFORE EACH USE

CHECK FOR LOOSE HARDWARE

- Make a thorough visual check of the unit for any bolts and nuts which may have become loose. Retighten any loose nuts and bolts

CHECK TIRE PRESSURE

- Check tire pressure regularly. The recommended tire pressure is printed on the tire.

CHECK ENGINE OIL LEVEL

- Check oil level before each use. Maintain engine oil as instructed in engine manual.

LUBRICATION

- Use a light machine oil to lubricate the axle where the hitch tongue pivots and the latch and pivot bolt at the beginning of each season.
- Grease or oil wheel bearings, using automotive wheel bearing grease at least once every season.



WARNING: Always stop engine and disconnect spark plug wire before lubricating, cleaning or before maintenance or repairs.

ENGINE MAINTENANCE

- Check oil level before each use, maintain engine oil according to the engine manual
- Service air cleaner after every 25 hours of normal conditions. Under extremely dusty conditions, clean every few hours. Poor engine performance usually indicates that the air cleaner needs to be serviced.
- Clean spark plug and reset gap once every season. It is recommended that the spark plug be replaced at the start of each season. Check the engine manual for the correct spark plug and gap specifications.

CLEANING

- Clean the unit after each use. Grass clippings and leaves can mildew and cause damage if not properly cleaned.
- Clean the engine regularly with a cloth or brush. Remove all dirt and debris from muffler area.

Exhaust Hose Installation

For proper hose attachment, try to keep the hose level or below where it connects to the cart. Trim the hose if necessary.

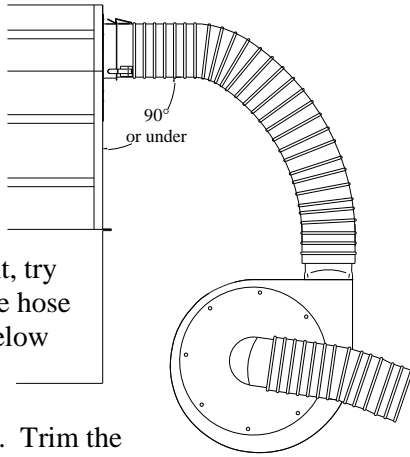

CORRECT

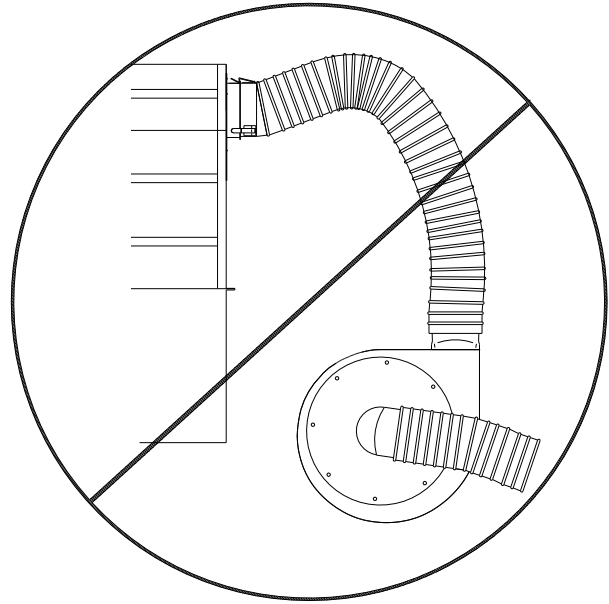

INCORRECT

NOTES

OPERATING PROCEDURE



BEFORE STARTING, Follow the engine manufacturer's instructions in preparing engine for operation. Never fill fuel tank indoors, with engine running or while engine is hot. **Do not smoke while filling tank.**

1. Inspect area to be vacuumed and pickup all harmful objects and litter. Rocks and other harmful debris can do serious damage to vacuum assembly and cause bodily injury.
2. For best vacuuming results operate tractor at manufacturer's recommended speed for best cutting. If grass is high, mow first and vacuum on the second pass.
3. Your vacuum is preset to run at approximately 3800-RPM (385), at no load. Do not slow down engine.
4. **SHUT OFF ENGINE TO UNLOAD.**
5. When operating tractor on slope or grade, exercise extreme caution. Do not cut across grade or slope. Mow directly up and down hills.
6. Periodically check all fasteners for tightness.
7. Listen for unusual vibration of engine or air turbine. If excessive vibration is present, **STOP** engine and check for damage to turbine fan.
8. Always shut off tractor engine and vacuum engine before servicing.
9. Replace deflector shield when discharge chute is removed.
10. When removing clogs, **SHUT OFF ALL ENGINES** and **wait for all moving parts to come to a complete stop! Failure to do so can cause serious bodily injury!**
11. Do not tow unit on public roads
12. Do not carry passengers on unit.
13. Avoid sudden turns or maneuvers.



CAUTION!!!!
SPINNING BLADE

EXTENDED STORAGE PROCEDURES

1. Wash and clean vacuum, and lubricate any lubrication points.
2. Drain fuel from the tank and run vacuum until fuel is exhausted in carburetor.
3. Drain and change the engine oil.
4. Clean tires and check pressure. Raising and supporting unit with weight off tires is recommended.
5. When storing a unit with Rubbermaid® containers, remove containers, remove clevis pin from top support, and rotate top around to completely open.

TRAC VAC WARRANTY POLICY

Midwest Equipment Manufacturing, Inc. will repair or replace, free of charge, any part, or parts that are defective in material or workmanship or both for a period of one year residential use, and 90 day's for commercial and rental use. The purchaser will pay transportation charges on parts submitted for replacement under warranty. For warranty service, contact your local dealer from whom the unit was purchased. There are no other express or implied warranties. Some states do not allow limitations on how long an implied warranty lasts, and some states do not allow the exclusion or limitation of incidental or consequential damages, so the above limitation and exclusion may not apply to you. This warranty gives you specific legal rights and you may also have other rights, which vary from state to state.

MIDWEST EQUIPMENT MANUFACTURING, INC.-5225 Serum Plant Rd.-
Thorntown, IN 46071

Phone: 1-800-Trac-Vac

Web Page: www.trac-vac.com E-Mail: sales@midmfg.com